



Points Import

About

Points import is used when you want to **work with points from outside of Locus** - websites, apps, add-ons etc. Either you choose the data yourselves or Locus Map receives them.

1. Launch import

There are a few ways:

- **Menu > (more functions) > Import** - general import for [both points and tracks >>](#)

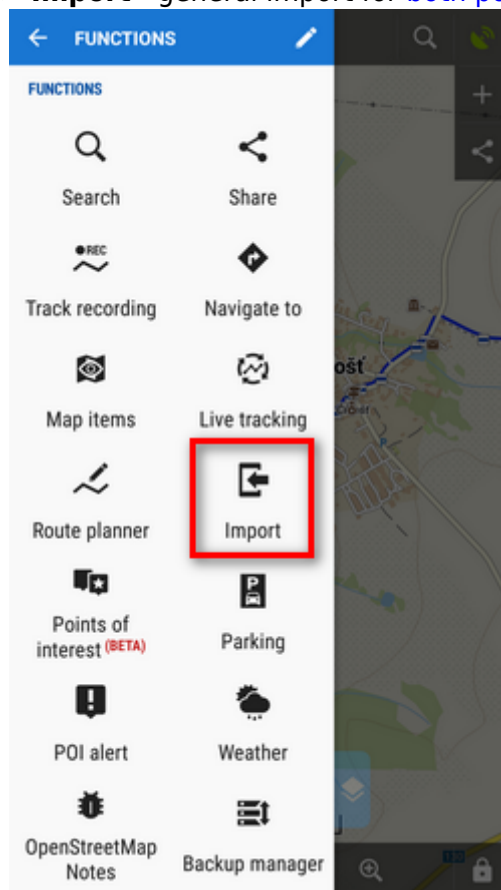

- **Menu > Points >  > Import**

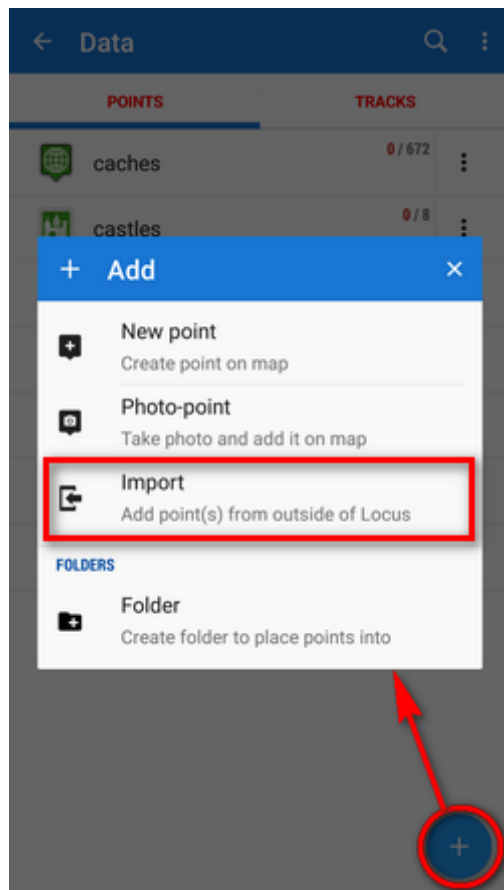

- **(Menu) > Points > any folder menu > Import** - imports directly into the selected folder

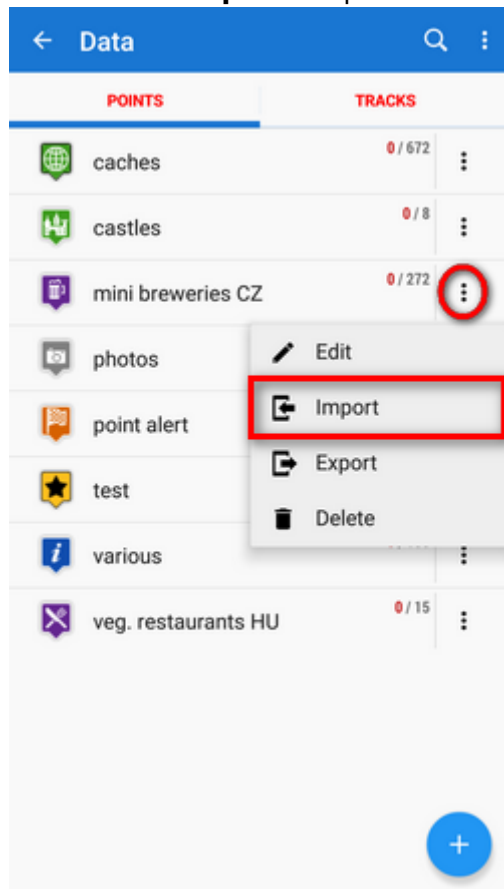

2. Select the file to import

Locus file browser opens the last used memory drive. **Importable files are in full color and are clickable** (more about supported formats see below):

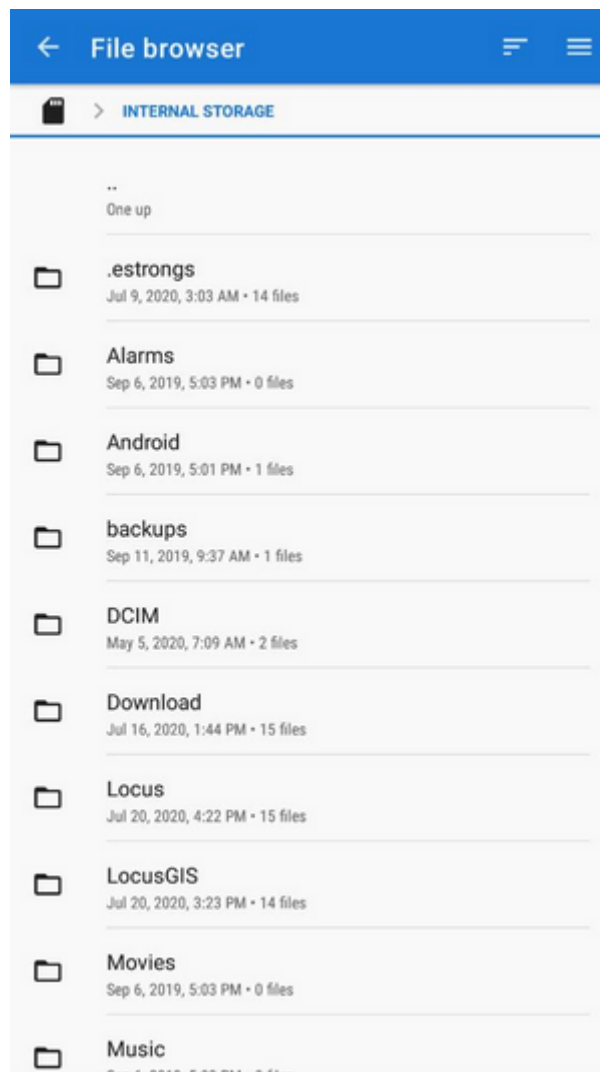

You can sort the files by **name, size and creation date**:

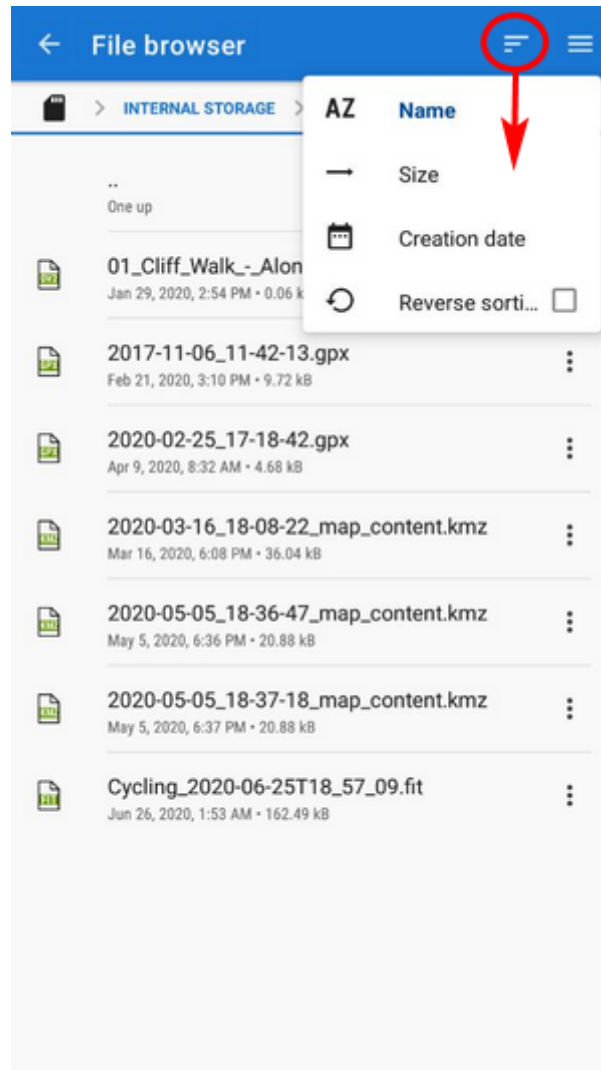

Other available drives can be switched from the topbar menu:

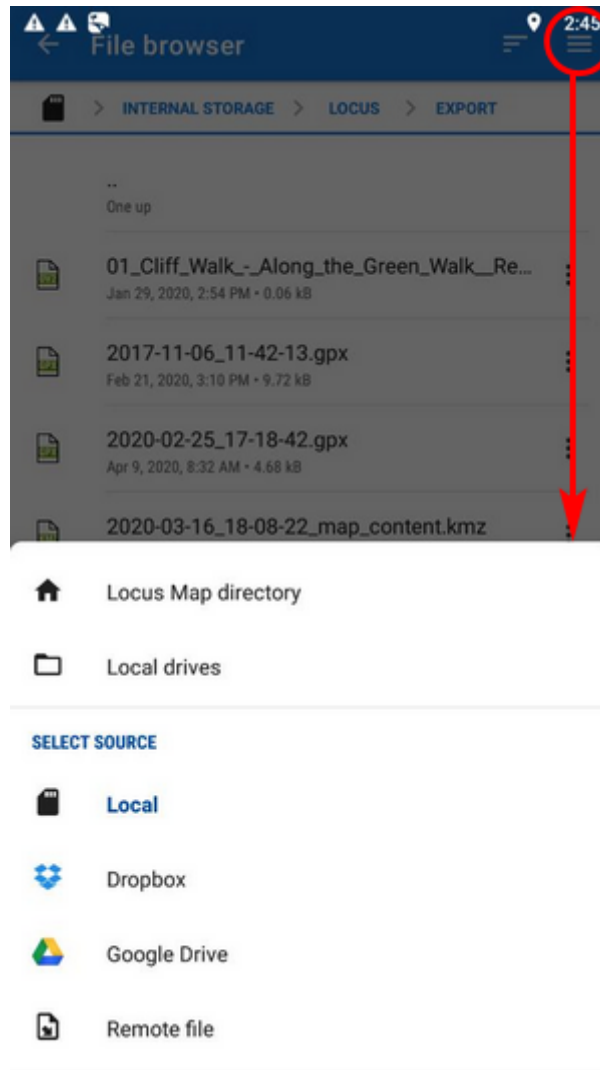

- **Locus Map directory** - the content of the app's main working directory
- **Local drives** - list of local memory drives (usually the Internal and external SD card code name)
- **Local** - the content of the app's main working directory
- **Dropbox** - contents of your Dropbox. Dropbox login is required when using the drive for the first time. Logout option is included.
- **Google Drive** - contents of your Google Drive. Google Drive login is required when used for the first time. Logout option is included.
- **Remote file** - a field for inserting a URL of a remote file stored on the internet

3. Select where to import

After selecting the file or receiving it from some external application or add-on Locus Map analyses it and modifies the import dialog according to the content - the dialog can process points or tracks or both of them at once.

Point import dialog

Appears when the imported file contains just points:

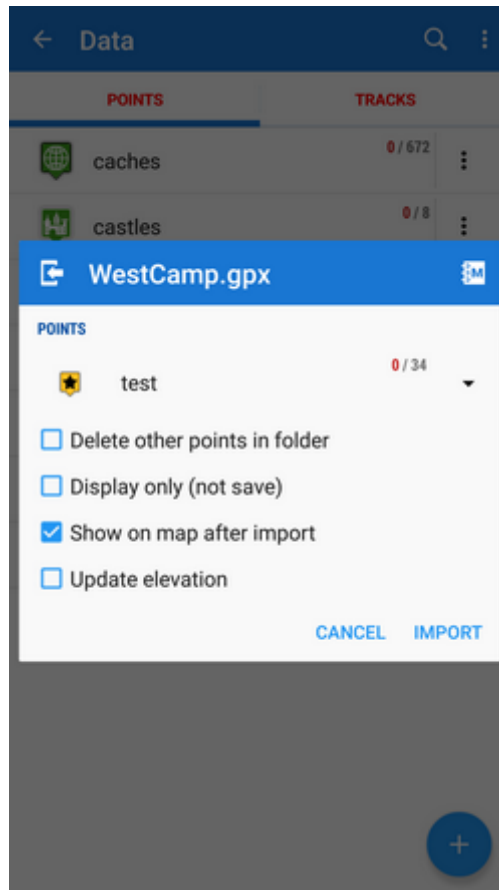

- topbar displays the file name
- **Folder selector** - selects the folder into which the file will be imported. It is possible to create a new folder directly from the menu. If you start import from a *folder action menu* in *Points manager* it is already pre-selected.
- **Delete other points in folder** - removes all other points from the selected folder before the import
- **Display only (not save)** - points are just displayed on the map screen - useful for a quick preview of the imported file
- **Show on the map after import** - displays imported points on the map when the import is finished
- **Update elevation** - adds or updates the value of imported points' elevation (both only if the offline elevation data is available)
- **Cancel** - aborts the action
- **Import** - confirms the action

Supported file formats

Locus Map is able to import the following file formats:

-  **KML and KMZ**

Supported both for *Import* and *Export*

[Keyhole Markup Language](#) is XML based plain text format with really wide range of usage. Since the version 2.2 KML format is standardized by OGC so it is used by many web/desktop/mobile applications as well as Locus Map.

-  **GPX**

Supported both for *Import* and *Export*

[GPS eXchange format](#) is an XML based text format used for handling points, tracks and routes. Locus fully supports all valid tags. More detailed description of GPX format is available on this [Wikipedia page](#).

-  **OpenAir**

[OpenAir](#) is a special format used by aircraft pilots and navigators for defining air spaces and areas.

-  **LOC**

[Location file format](#) is free but a little bit limited format for importing POIs or waypoints

-  **Ov2**

[TomTom](#) format for POI database.

-  **Upi**

[Sygic](#) format for POI database.

From:

<https://docs.locusmap.eu/> - **Locus Map Classic - knowledge base**

Permanent link:

https://docs.locusmap.eu/doku.php?id=manual:user_guide:points:import

Last update: **2020/07/28 14:45**

