

2. Set distance and alarm frequency

- open **Basic** tab:

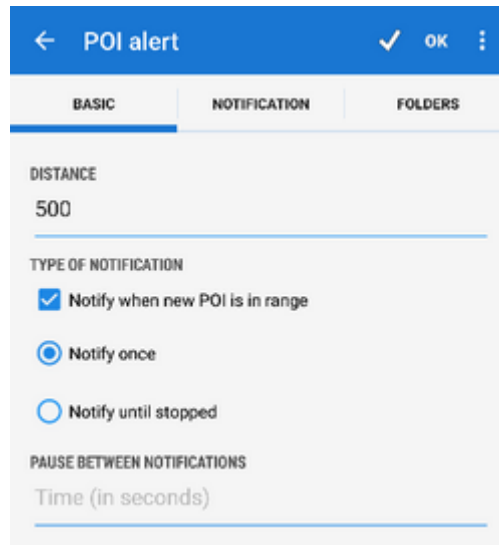

- **Distance** - set how far from the selected point Locus starts the alert
- **Notify when point is in range** - check to switch sound/vibration notifications on/off (visual notification on map stays on)
- **Notify once** - the alert goes on only once
- **Notify until stopped** - notification repeats in defined interval until stopped manually (red STOP button on screen) or when you're out of the alert distance.

3. Set type of notification

Open **Notification** tab:

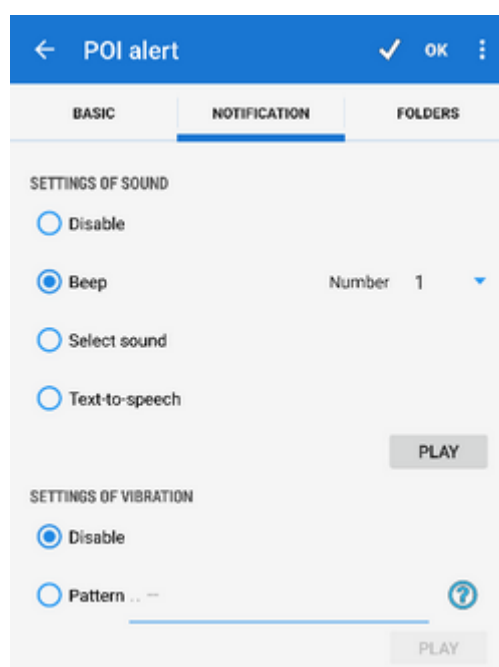

Settings of sound

- **Disable** - all sounds are disabled, only screen and vibration alert work
- **Beep** - select number of beeps (1-10)
- **Select sound** - select any sound stored in your device memory
- **Text-to-speech** - enables voice prompts notifying of the name, distance, and direction of the point
Tap **Play** to check your sound settings.

Settings of vibration

Visible only when the vibrator is present (mainly in mobile phones)

- **Disable** - the device does not vibrate on notifications
- **Pattern** - set notification vibrating pattern, using three symbols: '.' for 200 milliseconds vibrations, '-' for 500 milliseconds vibrations and ' ' (space) for 500 milliseconds of silence.
Tap **Play** to check your vibration settings.

4. Tap START in the topbar

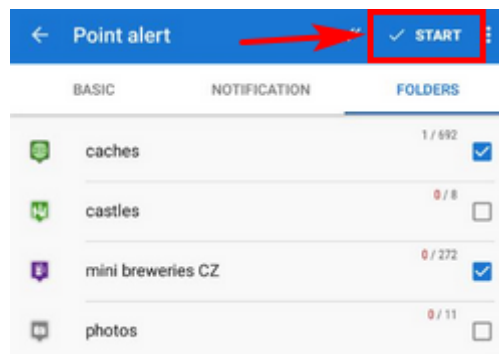

Setup change and point alert stop

Point alert setup can be changed anytime, even when the feature is running.

- scroll down your system toolbar and tap the point alert notification

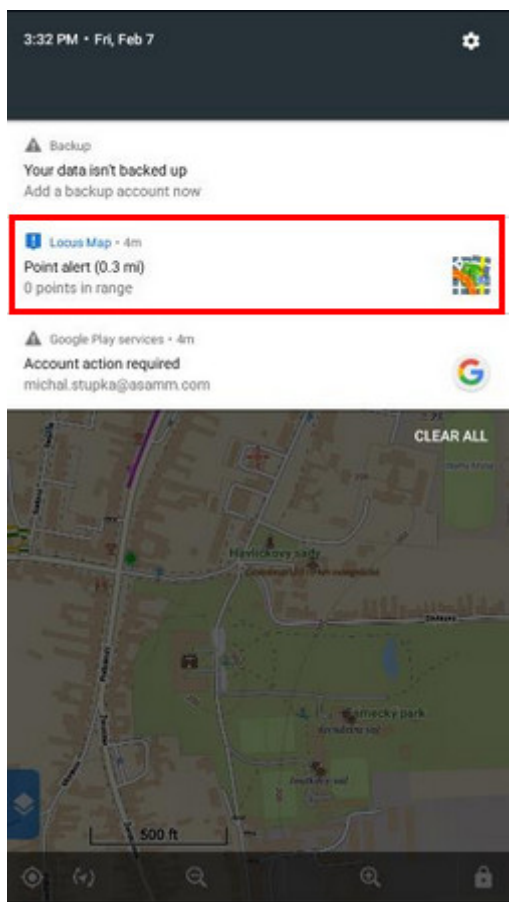

OR tap the point alert button in Locus menu:

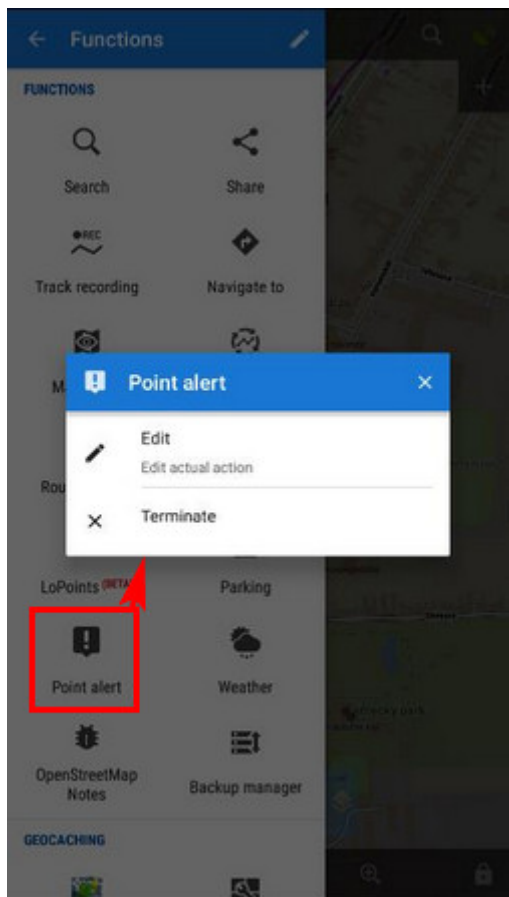

- select **Edit** - you can change distance, type of notification and point folders. Then tap START

again for the changes to take effect.

- tap **Terminate** to stop the point alert

From:

<https://docs.locusmap.eu/> - Locus Map Classic - knowledge base

Permanent link:

https://docs.locusmap.eu/doku.php?id=manual:user_guide:functions:poi_alert&rev=1581087018

Last update: **2020/02/07 14:50**

