



Guidance



Guidance To a Point

Off-road, beeline guiding to a selected place, independent on road network. Used especially for orientation in free terrain.

Typically useful for finding **geocaches** or directing towards **user point of interest** and **LoMap POI** (remote viewpoint, waterfall etc.):

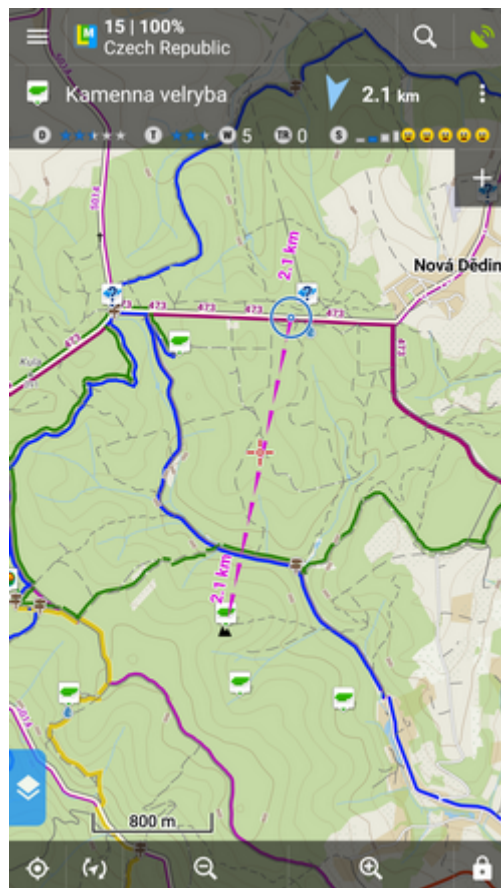

How to start guidance? Select target and start guiding to it.

Select target and start

A particular point on map

- tap the point on map
- tap > and then ➔🎯 **Guide On:**

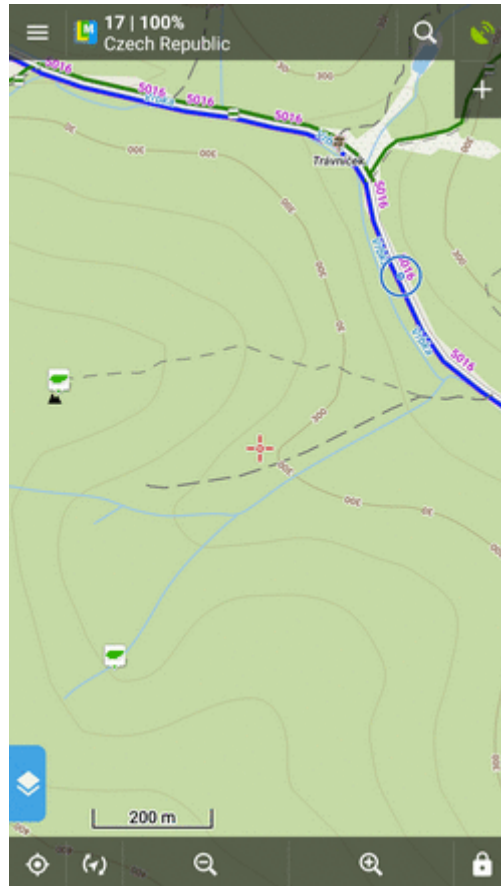

Indefinite place on map

- long-tap a place on map
- a pop-up (usually with address) appears
- tap > and then ➔🎯 **Guide On:**



In Points manager

- go to **Menu > Points > folder > tap the selected point** and open its detail screen
- tap  in the bottom panel and select  **Guide On:**

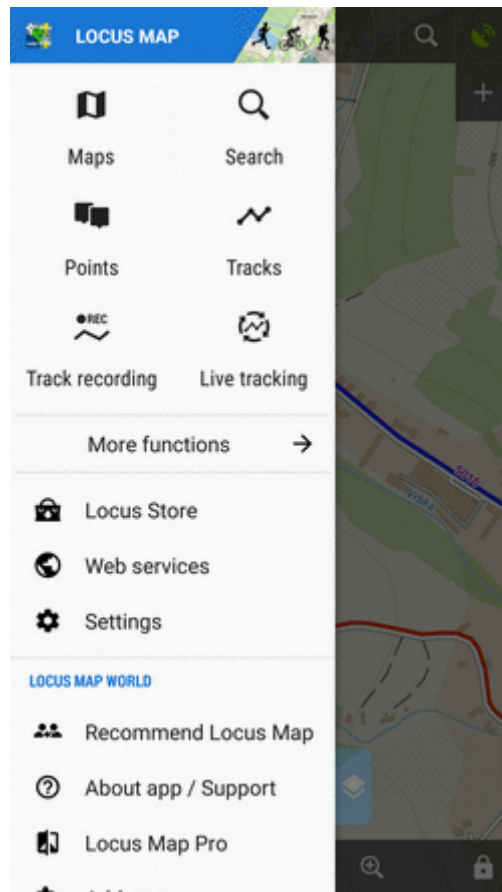

Controlling

Guidance panel

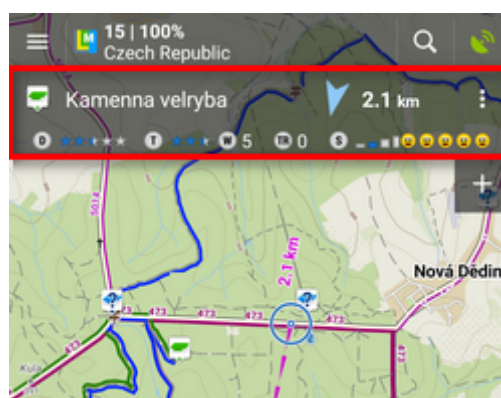

It displays information about the point, its distance and direction. In case of guidance to a geocache there are also other facts like the cache type, difficulty and terrain. Tapping the panel displays the point detail screen.

Panel menu

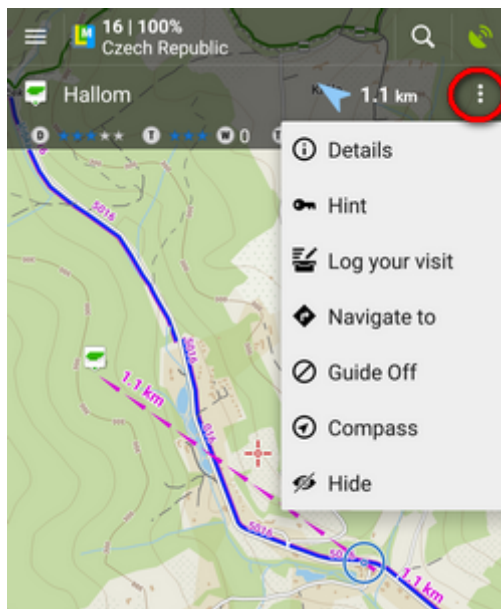

- *Details* - opens screen with the point details
- *Hint* - in case of guidance to a geocache
- *Load all waypoints* - in case of guidance to a geocache with more waypoints
- *Navigate to* - switches to turn-by-turn navigation and calculates a route to the target
- *Guide Off* - stops guidance
- *Compass* - switches into [compass](#) view
- *Hide* - makes the point invisible on map

Set notifications

Locus can notify you of the target several ways:

- when you **reach defined distance** from the point of guidance
- **repeat notification** after you reach defined distance
- **increase frequency of alerts** when getting nearer the target

Settings

- go to **Menu > Settings > Guidance > Notification**
- Switch **Notification ON**
- Select notification **mode** - single alert, repeated or increased frequency alert
- Set the **distance** you want to be alerted at (or distance interval between repeated notifications).

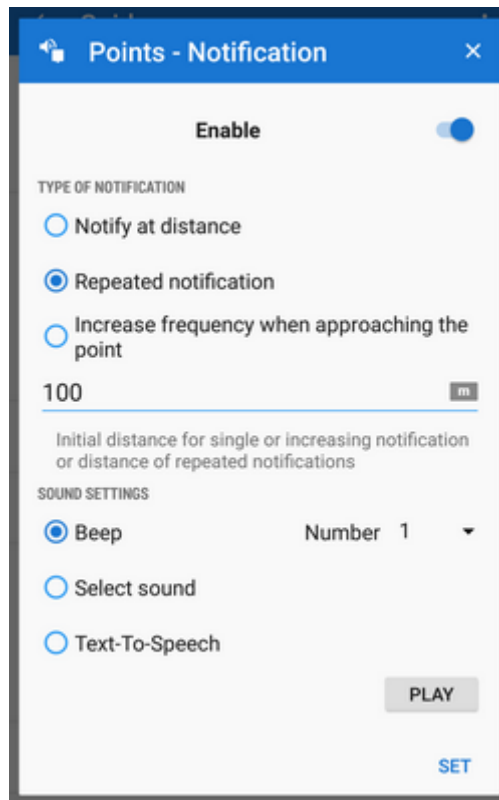

First two options have further settings:

- **Settings of sound**

- *Disable* - all sounds are disabled, notification is made by the device screen and vibrator only
- *Beep* - it is possible to set number of beeps (1-10)
- *Select sound* - select from sounds stored in your device memory
- *Text-To-Speech* - voice notification informing about distance and direction of the point. Tap **Play** to check your sound settings.

- **Settings of vibration** - visible only when the device is equipped by a vibrator (mainly mobile phones)

- *Disable* - the device does not vibrate on notifications
- *Pattern* - sets notification vibrating pattern, using three symbols: '.' for 200 milliseconds vibration, '-' for 500 milliseconds vibration and ' ' (space) for 500 milliseconds of silence. Tap **Play** to check your vibration settings.

Automatic zooming

Locus can zoom the map **automatically according to the distance from the point** you are guided to - the closer the target is the bigger zoom is displayed so both your position and the target are visible on the map screen:

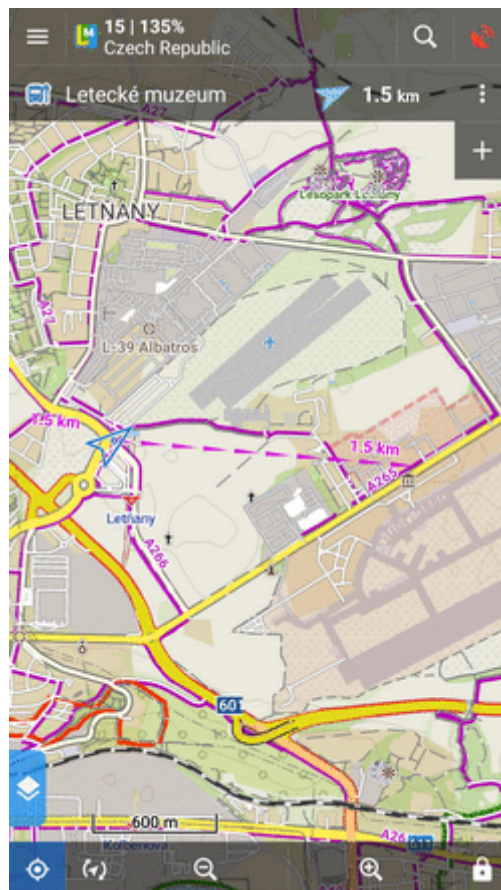

The option can be switched on in **Settings > Controlling > Map screen > Zoom according to speed**.



At first the function zooms according to your current speed, beginning at 2000 m from the target it switches to the distance-based zooming mode. Applicable only for guidance to a point (not along a route).

Automatic screen on

To save your battery energy you can set automatic screen turning-on. The screen lights up simultaneously with the sound notification.

You can set it up in **Settings > Controlling > Display > Screen on/off control**:

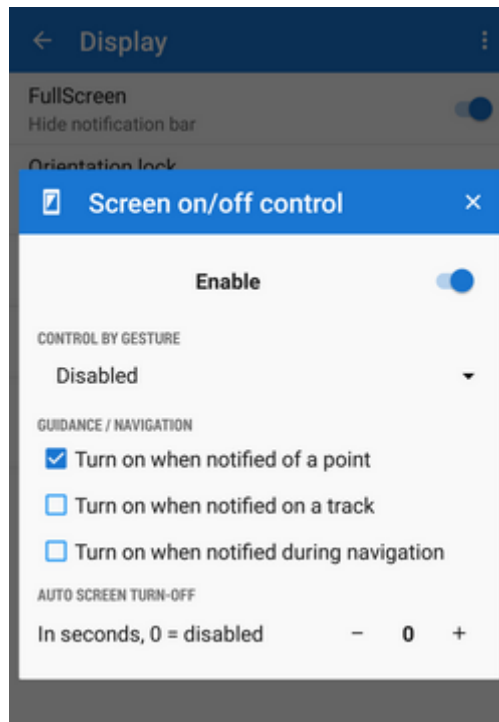



Guidance Along a Route

Technically it is actually **guidance to a chain of trackpoints**. You are guided to the first point of the route, then to the second etc. It is useful e.g. for **sailing, sea-kayaking, flying or crosscountry hiking** when there are no roads for turn-by-turn navigation.

Select route and start

On map

- Menu (or top panel > Data manager) > Tracks tab
- tap the selected track to display the detail screen
- bottom panel >  Navigation/guidance button >  Guidance (check Guide reversely if you need reverse guiding)
- a line with the indicator of distance stretches between your position and the starting point
- direction-change waypoints emerge on the route line
- an additional upper bar emerges



Alternatively the guidance can be started by selecting the track directly on map if it is visible, tapping the arrow button and selecting Navigation/guidance > Guidance.

- Locus Map can **alert you of the next direction change** (if you [set it up](#)) by a sound signal

and switching the display on (must be [pre-set](#) as well).

Route guidance control bar

-  **Guidance button**



- *information* - detail info on the track
- *nearest point* - guidance to the nearest point of the track (it does not have to be the starting point)
- *next point* - guidance to the nearest trackpoint of the previous one
- *guide off* - aborts the guidance
- **two optional fields** - tapping them unfolds a menu of features to display:
 - *Distance to target* (default)
 - *Time to target* - estimated time calculated upon your average speed
 - *Time of arrival* - estimated arrival time calculated upon your average speed
 - *Name of next waypoint* - in case the waypoints are named
 - *Distance to next waypoint*
 - *Time to next waypoint* - estimated time calculated according to current speed
 - *Time* - device clock
 - *Altitude* - current altitude of the user, calculated from GPS or the device barometer
 - *Speed*

From:
<https://docs.locusmap.eu/> - **Locus Map Classic - knowledge base**

Permanent link:
https://docs.locusmap.eu/doku.php?id=manual:user_guide:functions:guidance&rev=1542984320

Last update: **2018/11/23 14:45**

