

Backup Manager

We strongly recommend to back up your Locus data - **settings, points and tracks**. This tool enables to define **periodic automatic backups** and trigger **one-time backups**. Backup manager is also an essential tool for **transferring the application data from one device to another**.

Automatic Backup

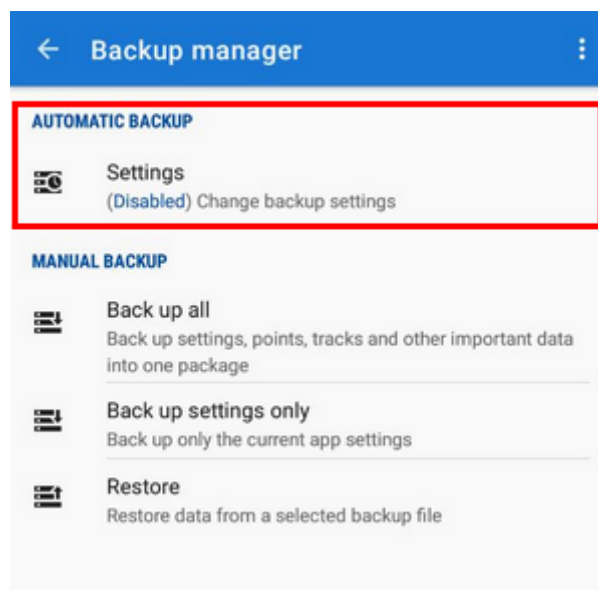

... saves settings, points and tracks periodically to *Locus/backup/auto* directory and optionally to **Dropbox or Google Drive**. How to set it up:

1. **Enable** automatic backup
2. Set **repetition frequency**, **number** of stored backups and backup to **cloud** (optional but strongly recommended):

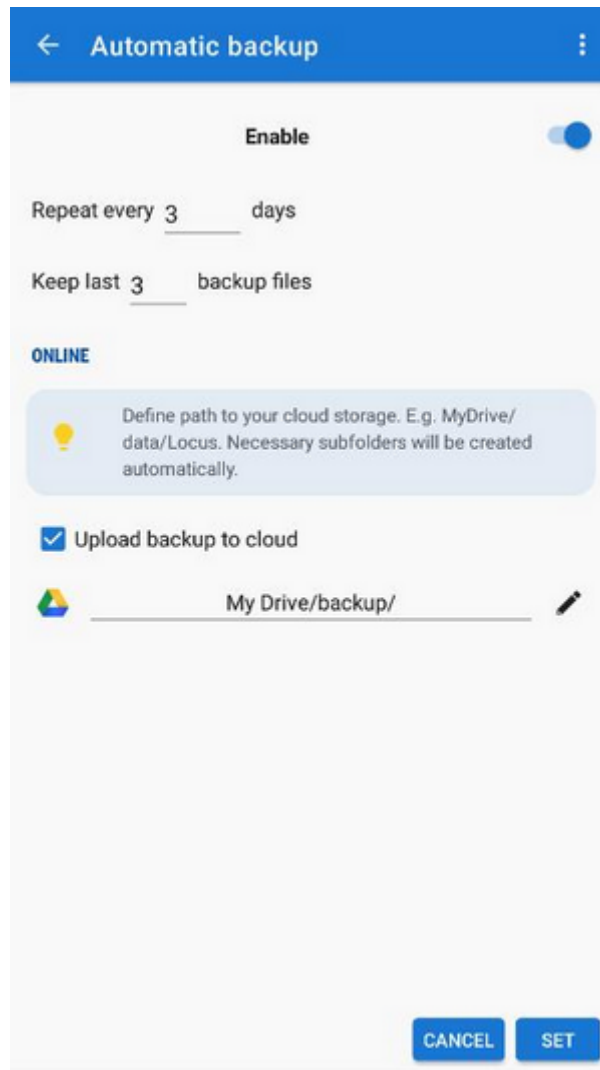

Backup to cloud

Automatically saves Locus settings, points and tracks to your selected directory at Dropbox or Google Drive. Make sure you have **applications of the services installed on your device**.

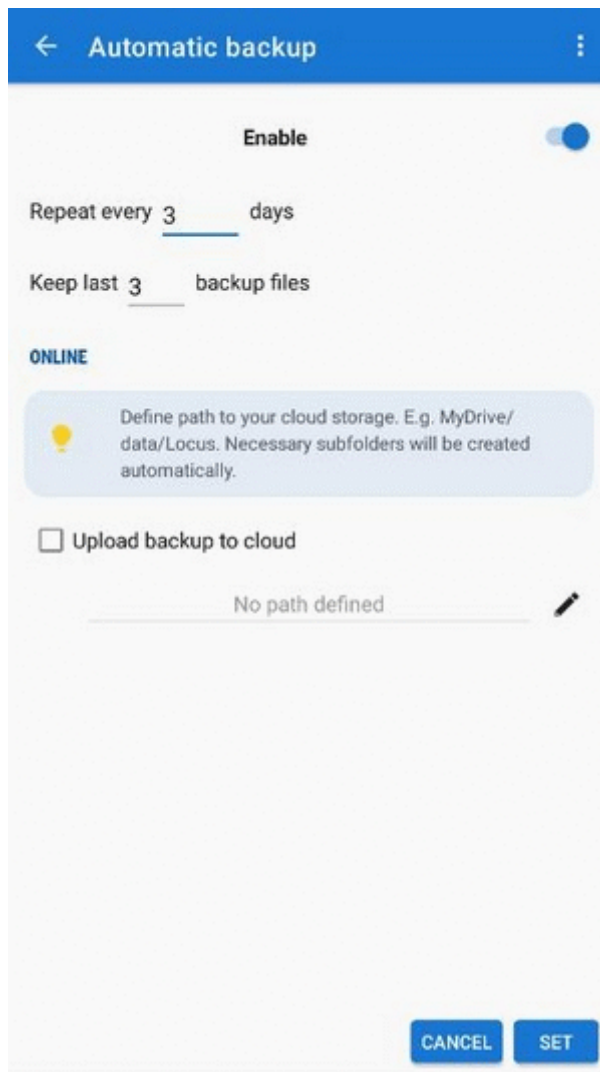

- First use of this feature requires login to your cloud service account
- Cloud backup is available only on devices with Android 5.0 and newer

Manual Backup

Saves a single backup file with Locus data to *Locus/backup/* directory (it can be changed in *settings > miscellaneous > default directories*). The file name is by default its **time stamp** but it can be changed.

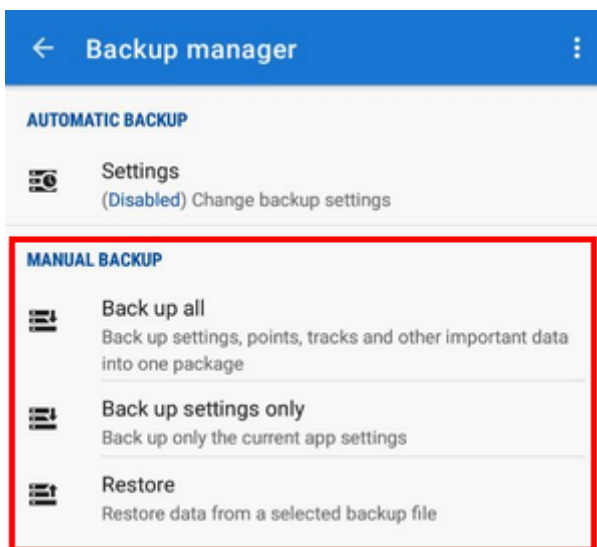

- **Backup all** - creates a backup of **all settings, points and tracks** in one package.
- **Backup settings only** - creates the settings backup package. Useful if you use various sets of app properties.

Backup sharing

After the backup file is created you can **share** it - **send it to Dropbox, email it, share it on social networks** etc. Just tap  in the confirmation box:

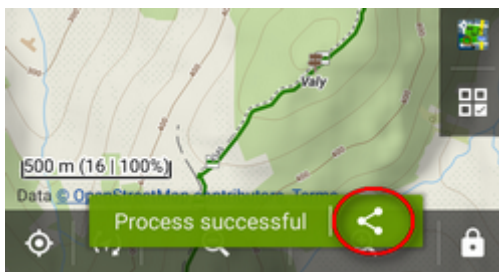

Restore

- opens the file browser with the last used drive - you can select **local memory (internal or SD card), Dropbox or Google Drive**
- find the backup directory (by default, it is /Locus/backup/) and **tap a backup file to restore**
- select **what content of the package you want to restore:**

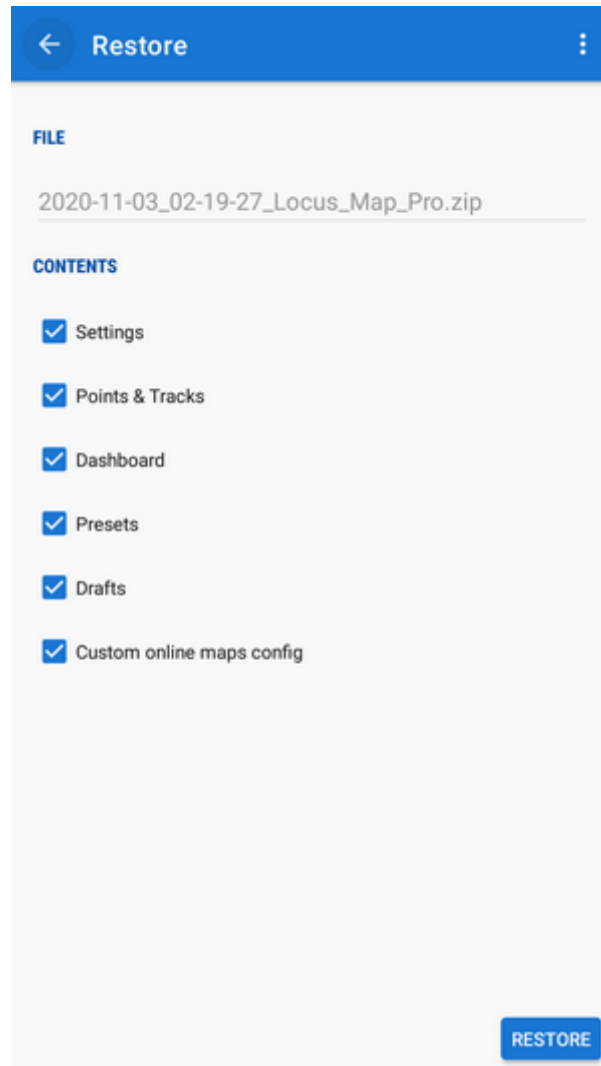

- **restart** the app

From:
<http://docs.locusmap.eu/> - Locus Map Classic - knowledge base

Permanent link:
http://docs.locusmap.eu/doku.php?id=manual:user_guide:tools:backup&rev=1604415846

Last update: **2020/11/03 16:04**

