



# Backup Manager

- Menu > More functions > Backup Manager

The Backup Manager enables **one-time backup of Locus settings, points and tracks** or defines **periodic automatic backups**. Backups can be also **shared** to your favorite **cloud services** and used for **transferring the application data from one device to another**.

## Manual Backup

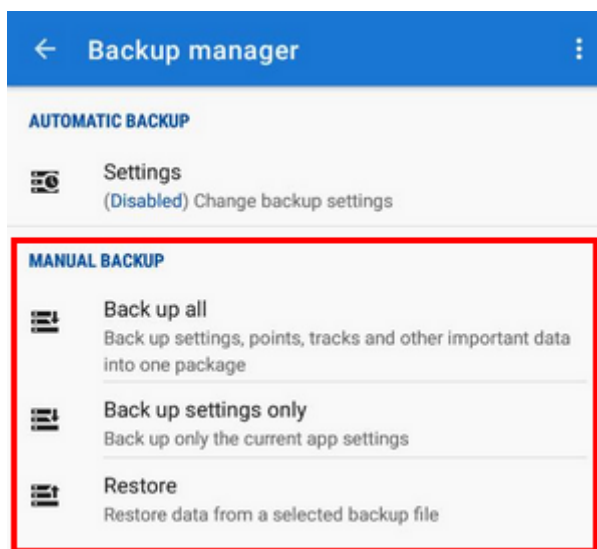

- **Backup all** - enables immediate **one-time backup of all settings, points and tracks** into one package. The **time stamp** is default as the package name but it is possible to change it. By default, the package is stored into *Locus/Backup* directory (it can be changed in *settings > miscellaneous > default directories*).
- **Backup settings only** - creates the settings backup package. Useful if you use various sets of app properties.
- **Restore** - shows content of */Locus/backup/* directory from which you can **select a backup file to restore**. In case of file with all backup you are prompted to select **what content of the package you want to restore**.

## Backup sharing

After the backup file is created you can **share** it - **send it to Dropbox**, **email it**, **share it on social networks** etc. Just tap  in the confirmation box:

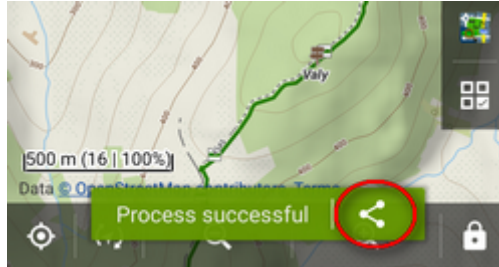

## Automatic Backup

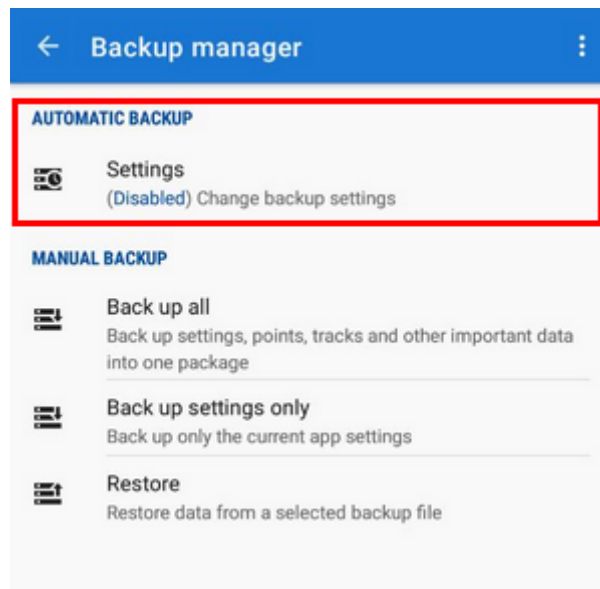

... saves settings, points and tracks periodically to *Locus/backup/auto* directory without user's interference. You can also set automatic backup to **Dropbox or Google Drive**.

1. **Enable** automatic backup
2. Set **date** of the next backup, **repetition frequency**, **number** of stored backups and backup to **cloud**:

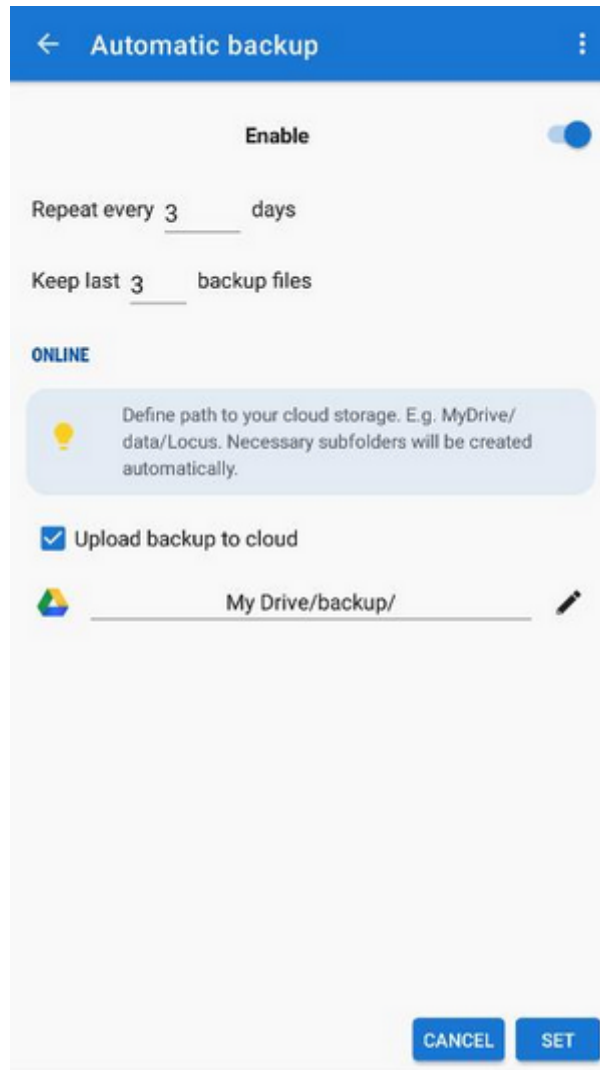

## Backup to cloud

Automatically saves Locus settings, points and tracks to your selected directory at Dropbox or Google Drive. Make sure you have **applications of the services installed on your device**.

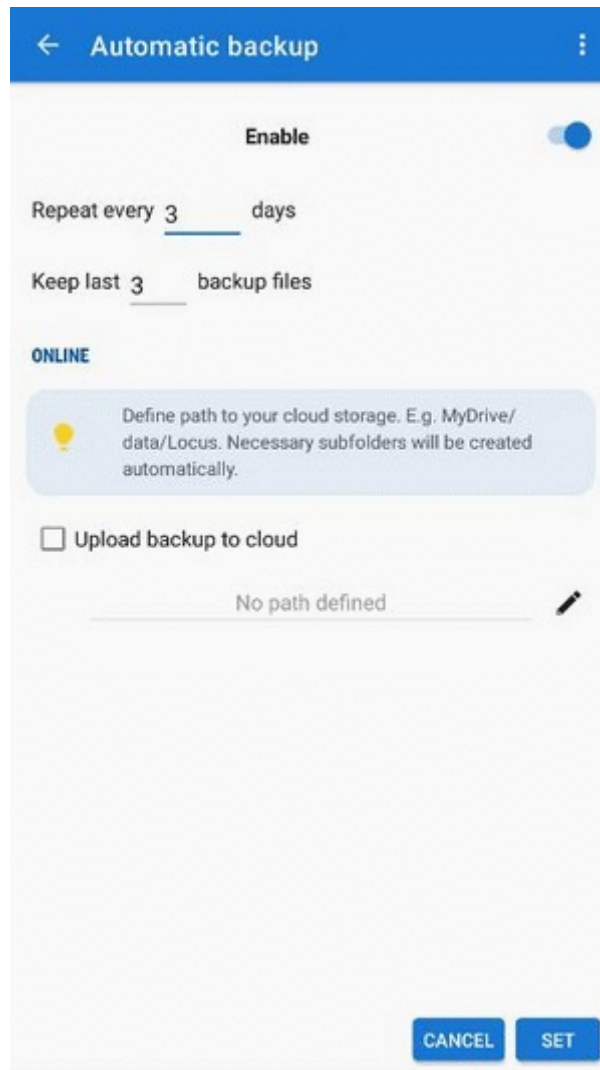

- First use of this feature requires login to your cloud service account
- Cloud backup is available only on devices with Android 5.0 and newer

## Edit and cancel

When the automatic backup is enabled the menu in the entry dialog offers option to edit its properties or cancel it:

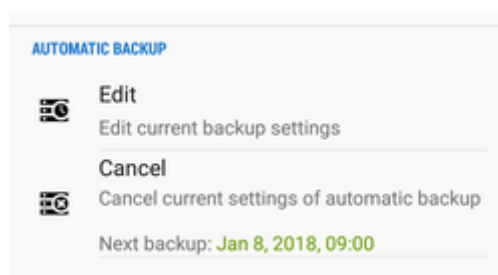

From:

<http://docs.locusmap.eu/> - **Locus Map Classic - knowledge base**

Permanent link:

[http://docs.locusmap.eu/doku.php?id=manual:user\\_guide:tools:backup&rev=1547641916](http://docs.locusmap.eu/doku.php?id=manual:user_guide:tools:backup&rev=1547641916)

Last update: **2019/01/16 12:31**

