

# Miscellaneous

---

## Global

### Run Locus Map as service

Increases system priority of Locus Map and secures it against automatic system task killing (unfortunately, not always, [see >>](#)).

### Default directories

Allows customizing Locus Map default working directories.

### Root directory

It is highly recommended to install and keep Locus root directory in your device's **internal storage**:

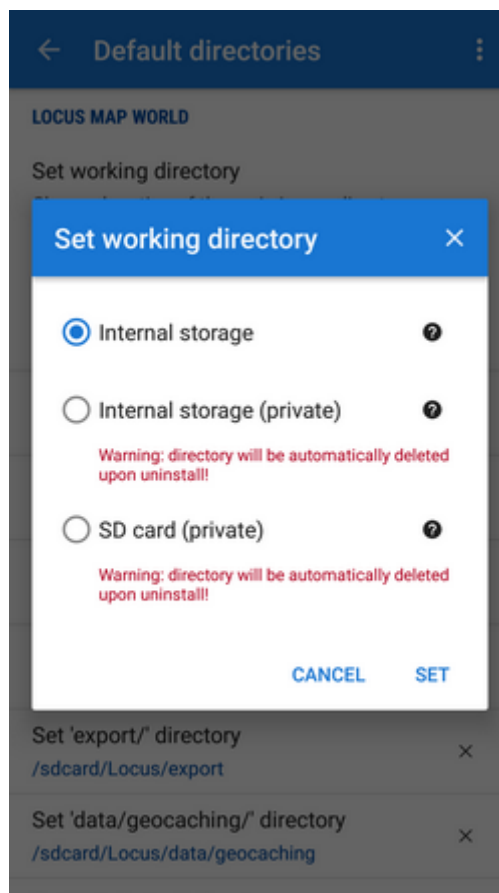

Other ways are either **impossible** (external SD card root directory since Android 4.4.2) or you can **lose your data (tracks, points, maps...) upon un(re)install** (external SD card private (Android-dedicated) directory)

## Working directories

Beginning with Android 5.0 it is possible to move /mapsVector/, /SRTM/ and /Backup/ directories to external SD card and redefine path to them here:

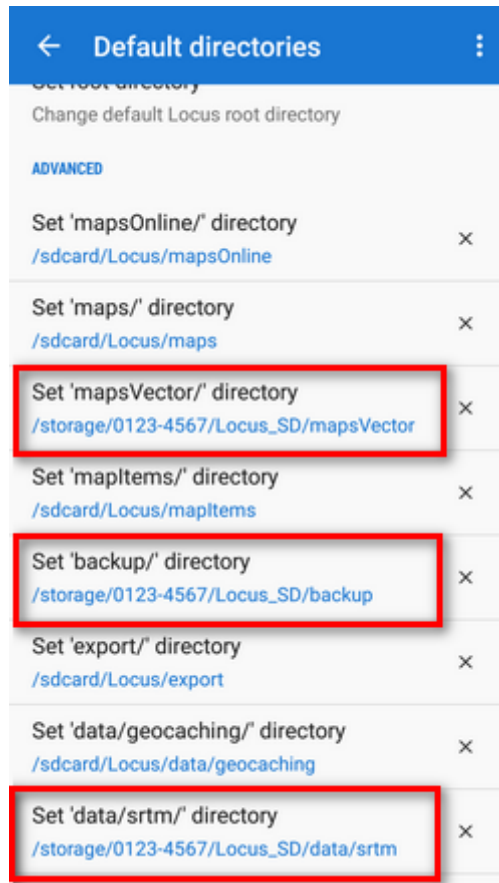

**Recommended setup of working directories for users of external SD cards are [HERE >>](#)**

## Data import & export

### Wifi-only upload

Control if you want to spend your mobile data on uploading maps, backups etc.

## Various

### Connect with add-ons

[Locus API](#) for developers enables creating various Locus add-ons for many off-core functions. Most of them need to receive periodical information about map cursor location, GPS, recorded distance etc., for example [Geocaching4Locus add-on](#) that is very important for importing geocaches to Locus Map.

## Source of online address search

Enables selecting from various address searching engines:

- **Google** - default search engine. Returns very precise data but is functional only on devices officially supported by Google and associated with a Google account.
- **GraphHopper** - returns less precise data than Google in most cases but is functional on all devices
- **MapQuest** - returns less precise data than Google in most cases but is functional on all devices
- **Bing** - another alternative to Google by Microsoft

## Audio channel

Selects audio channel and its volume setting for notifications:

- **Music stream**
- **Notification stream**

## Promo notifications

Here you can switch on or off [on-screen notifications](#) of news from [Locus web site](#) (blogposts about various Locus tricks, new features, maps or traveling tips)

## Clear temporary data

Deletes temporary storage folders:

- **Temporary files** - deletes cache directory
- **Cache of online maps** - deletes all cached online map tiles
- **Unneeded geocaching data** - deletes all cached data of geocache points that have been removed before
- **Unused attachments** - deletes all data linked to previously removed points



**Warning:** after performing this procedure all icons will have to be re-uploaded and new map initialization files will have to be created

## Reset preferences

Resets all settings to default state after Locus Map installation. **Reset does not delete your data - tracks, points nor maps.**

From:  
<http://docs.locusmap.eu/> - **Locus Map Classic - knowledge base**

Permanent link:  
[http://docs.locusmap.eu/doku.php?id=manual:user\\_guide:settings:misc&rev=1571306533](http://docs.locusmap.eu/doku.php?id=manual:user_guide:settings:misc&rev=1571306533)

Last update: **2019/10/17 12:02**

